



Maxi Linux Remote Control User Guide



1. Remote control layout

- 1 TV input source select
- 2 TV/AUX power/standby
- 3 Colour navigation
- 4 Replay VOD or recorded video
- 5 Set-top box (STB) PVR* transport
- 6 Electronic Program Guide
- 7 Navigation and OK
- 8 Back
- 9 Volume up and down
- 10 Channel select and text entry
- 11 Go to Live TV
- 12 Option (mapped by your service provider)
- 13 Infra-red (IR) window
- 14 STB power/standby
- 15 VOD menu
- 16 Forward VOD or recorded video
- 17 Information
- 18 Exit
- 19 Menu (for STB)
- 20 Channel/Page up and down
- 21 Mute
- 22 Subtitles/Closed captions
- 23 DVR /recordings menu
- 24 Low battery warning LED

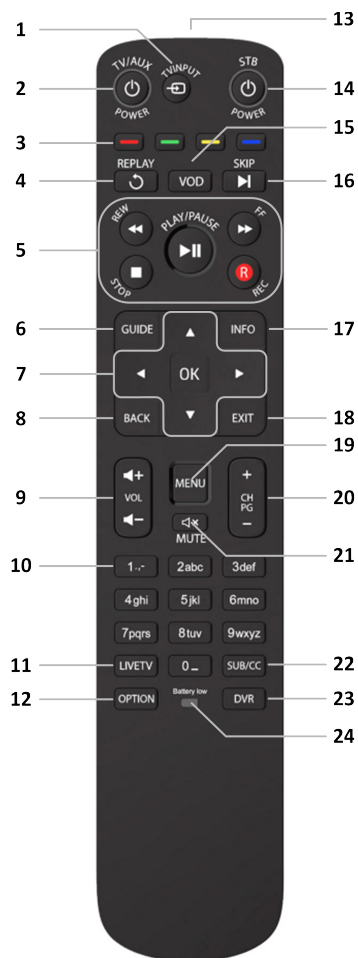

Note: Some functionality may not be available on specific models of STB, also functionality may vary with the TV service delivered by your service provider.
*Personal video recorder - available on some models of STB

2. Inserting batteries

- 1 Slide the battery housing cover downwards to remove
- 2 Insert two AAA batteries observing the correct polarity
- 3 Refit the battery housing cover

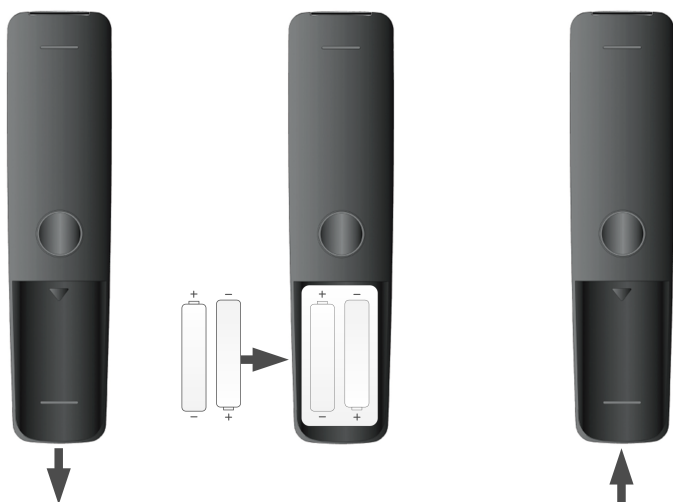

Battery information

Do not mix different types of battery or old and new batteries.

Do not use rechargeable batteries.

Do not attempt to recharge the batteries.

Remove the batteries from the remote control if you are not going to use it for several weeks, to avoid the risk of leakage.

Please respect your environment and any local regulations and dispose of old batteries in a responsible manner.

Immediately remove any leaking batteries.

Take care when handling leaking batteries as they may cause burns to the skin or eyes, or other physical injuries.

3. Operation

When you use the remote control, point it towards the front of the set-top box (STB). Do not cover the infra-red (IR) window at the front of the remote control and at the front of the STB.

If you press a key for more than 30 seconds the remote control will stop transmitting commands to preserve battery life.

4. Controlling the STB: pairing the remote control

To control your STB, you must pair it to your remote control using Bluetooth. Your remote control can only pair with one STB at a time.

If pairing instructions are shown on the TV (e.g. as a setup wizard), follow the instructions given. This depends on your service provider and if no instructions are shown, follow the instructions below.

During pairing no remote control keys will work except the STB key. You must press **BACK** to stop pairing or to use another function.

Ensure the STB is powered on, has finished its start-up procedure and the STB POWER key on the remote control is not illuminated.

Ensure your TV input source is set to the output from the STB.

Auto pairing

1. The remote control is in pairing mode:

- for 60 seconds after the batteries have been inserted or
- when any key is pressed to reset the 60 seconds timeout and the STB POWER key flashes to confirm the keypress.

2. Press any key to start pairing and follow the instructions on the TV (if shown).

3. If pairing is unsuccessful, press any key to reset the 60 seconds timeout.

Alternatively you can pair the remote control manually:

Manual pairing

1. Press **MENU** and **OK** until the STB POWER key flashes to acknowledge and 'Searching for accessories' is shown on the TV.

2. If pairing is successful the STB POWER key flashes once to confirm pairing. The STB may indicate this change, depending on the version of software installed.

If pairing is unsuccessful the TV/AUX POWER key gives a long flash to indicate an error.

Note pairing may not be successful on the first attempt. (The STB may indicate this change, depending on the version of software installed.)



5. Controlling the TV (brand search)

The TV/AUX POWER, TV INPUT, VOL+, VOL- and MUTE keys on the remote control can be programmed to operate your TV.

To do this, your remote control must first learn the 'brand code' of your TV. By default, the remote control is programmed with the most common brand code 1150 (Samsung).

1. Go to www.aminocom.com/legal/docs and select Remote Control User Guide to find the 4-digit brand code for your TV brand.

2. Make sure your TV is turned on. The STB does not need to be turned on for this operation.

3. Press **MENU** and **1** until the STB key flashes twice to show the remote control has switched to IR mode.

4. If you know your TV brand code press **2** and **6** until the TV/AUX POWER key flashes twice and remains on, then enter your 4-digit code.

If you don't know your TV brand code press **1** and **3** until the TV/AUX POWER key flashes twice and remains on, then enter **9999**.

5. If successful the TV/AUX POWER key will flash once and remain on.

If unsuccessful the TV/AUX POWER key will give a long flash and the remote control will revert to normal operation.

6. To check you can control the TV, press and hold either the **TV** or **MUTE** key. When the TV turns off or mutes, release the **TV** or **MUTE** key.

7. Press **Back** to leave the auto search mode.

If brand search is unsuccessful, then you are unable to use this feature with your TV.

Volume buttons control STB device: Menu and 4

- hold for 3 seconds.

Volume buttons control TV set: Menu and 3

- hold for 3 seconds.

6. Learning mode

The Maxi Linux remote control can learn a key function from another 'source' remote control.

1. Choose your 'target key' on the Maxi Linux remote control. It must be one of the following keys: TV/AUX POWER, TV INPUT, VOL+, VOL-, MUTE. Your target key will learn a function from the source remote control.

2. Press **4** and **6** until the TV/AUX POWER key flashes then remains on.

3. Press and hold your target key on the Maxi Linux remote control:

- if valid, the TV/AUX POWER key will give a confirmation flash.
- if invalid, or you do not press within 30 seconds, the TV/AUX POWER key will give a long flash and the Maxi Linux remote control will return to user mode.

4. Release your target key.

5. Hold the Maxi Linux remote control 3 - 6 cm from the source remote control with the IR windows facing each other.

6. Press your chosen key on the source remote control (On/Off, Source, Vol +, Vol -, Mute).

7. If the IR signal is received correctly, the TV/AUX POWER key will flash twice and the Maxi Linux remote control will return to normal mode (note: this can overwrite a previously learned code).

8. If the IR signal is not received correctly, or is received after 30 seconds, the TV/AUX POWER key will give a long flash and the Maxi Linux remote control will return to user mode.

9. If any key is pressed on the Maxi Linux remote control while it is waiting for an IR signal, the TV/AUX POWER key will give a long flash and the Maxi Linux remote control will return to user mode. (If the target key is pressed, any learned code on it is cleared.)

10. To clear the target key, press **4** and **6** for at least three seconds until the TV/AUX POWER key flashes and remains on. Press your **<target key>** twice. The TV/AUX POWER key will give a confirmation flash to confirm the target key is cleared.

7. Factory reset

A factory reset returns the remote control to its factory settings: Bluetooth mode, Samsung brand code (1150) and unpaired.

1. Press **1** and **6** until the TV/AUX POWER key flashes then remains on.

2. Enter the key sequence **981**

The STB POWER key will flash and the remote control will reset to its factory settings.